

LUXURY PEEL & STICK TILE

Not suitable for wet applications, including showers.

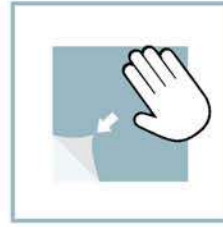
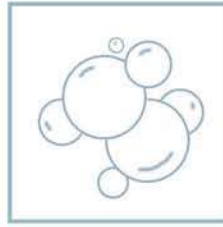
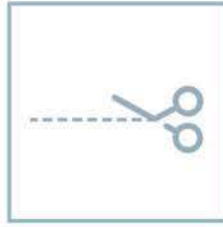
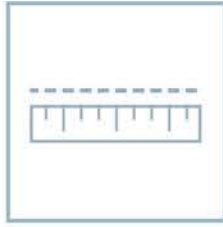

INSTALLATION IN 6 EASY STEPS

Before You Start

Safety First! Wear safety glasses and protective gear when performing any installation, even for something as easy as Luxury Peel & Stick. Cutting tile and working with tools is fun, but make sure to protect people, pets, and your favorite furniture and spaces. We want everyone to safely enjoy your beautiful tile project!

1 Clean & Prepare

Ensure that the wall or surface where you will be installing the tile is smooth and even. Use a damp sponge to wipe the surface to remove any remaining dust or debris and allow to air dry.

TileBar Tip: It's best not to use a lot of water on the sponge when you wipe down your surface. This will not only lengthen the amount of time it will take before you can install, but excess water could also damage the surface. Just a little water will clear away most dust and have you installing in no time!

2 Measure

Without removing the peel-away backing, lay out the tiles in the desired pattern. Measure the pattern and then mark on the wall or surface the location of where you would like to install, using a level to help make a straight line.

TileBar Tip: Clear out a flat surface on the floor or other workspace where you can lay out your entire pattern. This will allow you to see your design and not only get you excited about your amazing tile project, but also plan for any necessary cuts to the tile.

3 Cut Tiles

If it is necessary to cut a tile to fit it into your design, measure the tile and mark it using a straight edge. Cut the tile with appropriate tool for the tile type. Solid Polymer Core (SPC) tiles can be scored with a utility knife and snapped apart, but natural stone, mother of pearl and metal tiles will require the use of a saw. Please note that there may be more than one type of tile in a single mosaic pattern, so plan to use a saw for these products.

TileBar Tip: You can use a tile saw or a chop saw to cut the Luxury Peel & Stick tiles, but know your skill level! Make sure to use a saw type that you feel comfortable with and will give you the straightest edge possible.

4 Apply Soapy Water

Use a sponge or spray bottle to apply a thin layer of soapy water to the wall or surface to be tiled to allow for more time to place and adjust a sheet of tile.

TileBar Tip: Luxury Peel & Stick tiles have permanent adhesive on the back so that they will stay in place and perform just like traditional tile installation. The soapy water allows for a few minutes of time before the tile is set in place so that you can adjust a mosaic sheet during installation. Use 2-3 drops of dishwashing soap per cup of water.

5 Peel & Stick

Remove the peel-away backing from tile and place in desired location on wall or surface. When all the tiles are in place, press firmly to ensure that the mosaic tile sheets have a strong bond to the wall or surface.

TileBar Tip: Peel away only about 1/4 of the backing on a single sheet when you begin so that you can more easily place your tile. Slowly remove the rest of the film and press the whole sheet on the wall or surface. If you are installing interlocking tiles (mosaic sheets where the tiles fit together like a puzzle piece), place the interlocking parts together first, followed by the rest of the tile sheet.

6 Grout (if Required)

Most Luxury Peel & Stick tiles do not require grout thanks to their seamless design. If the tile does require grout, follow the manufacturer's instructions for proper installation.

TileBar Tip: You will want to use non-sanded grout for Luxury Peel & Stick tiles to protect the decorative finish of the product. [Click here](#) for some great non-sanded grout options and note that all TileBar products have grout color recommendations to make your selection that much easier.

888.541.3840
info@tilebar.com | **tilebar**